



## Glossop Job Centre

### REQUIREMENT:

The client needed a ramp solution installed quickly to the main entrance before the centre reopened on Monday.

Our modular ramp was the ideal choice, as our team typically complete installations within 24 hours, with the product ready for immediate use afterwards. Furthermore, we successfully accommodated the request for a weekend fitting, ensuring the project was delivered on time and without disrupting the weekly running of the centre.

### DESIGN PHASE:

Our in-house design team produced a detailed 3D model and 2D plan, providing the customer with comprehensive visualisations of the project. These were included with their quotation.

### APPLICATION

Public Building

### LOCATION

Glossop, Derbyshire

### SYSTEM

Standard Modular Ramp

### SERVICE PACKAGE

Supply & Installation

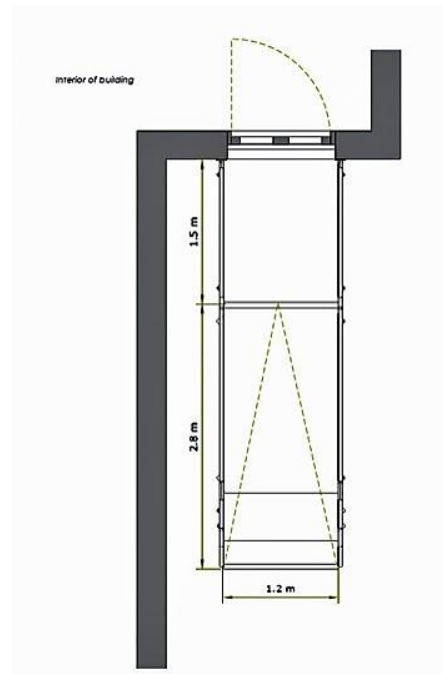
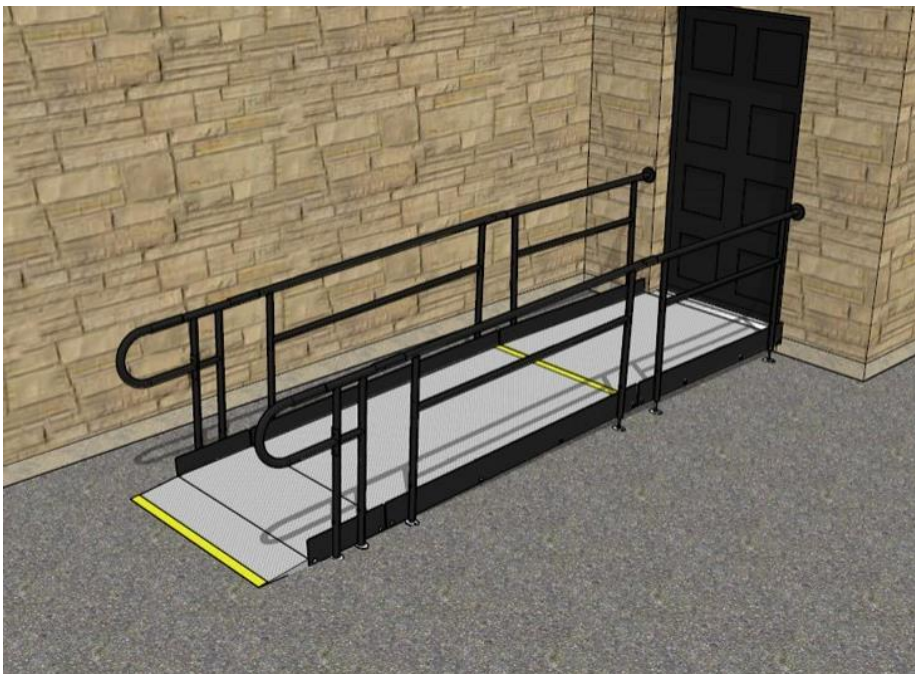

## INSTALLATION:

The fitters efficiently assembled the ramp in light snow in just a few hours.

Our modular ramps are designed to withstand most British weather conditions, allowing for quick installations without compromising quality. In contrast, traditional concrete ramps installations can take several days to cure and can be delayed by cold or wet weather, extending project timelines.

If you need to keep projects on track, regardless of the weather, our products and installation services are ideal. You can ensure timely delivery and client satisfaction while maintaining the highest standards of quality and safety.

### FEATURES INCLUDED:

- Adjustable Telescopic Legs - Adaptable to various threshold heights.
- Standard Handrail - This handrail system ensures that users always have a support to hold onto.
- Looped Trombone Ends – Prevents clothes from snagging at the ends.
- Standard Colour: Black - Powder-coated black finish for greater durability than traditional paint.
- Slip-resistant Mesh Platform - A multi-directional walkway with self-draining steel mesh and a galvanised finish.

### EXTRA FEATURE INCLUDED:

- Slip-Resistant Yellow Stair Nosings - Enhances visibility of system edges and level changes for users with impaired vision.

